

5 YR INV	SLD REV	BMP	EMP	INV	SLD REV
03/18/2013	04/18/2013	0.000	0.926	07/17/17 FRA	08/07/17 FRA
BY	BMCD				

FLORIDA DEPARTMENT OF TRANSPORTATION
STRAIGHT LINE DIAGRAM OF ROAD INVENTORY

SECTION STATUS	INT. or US ROUTE NO.	STATE ROAD NO.	COUNTY	DISTRICT	ROADWAY ID	SHEET NO:
02		SR A1A	BROWARD	04	86050100	1 OF 1

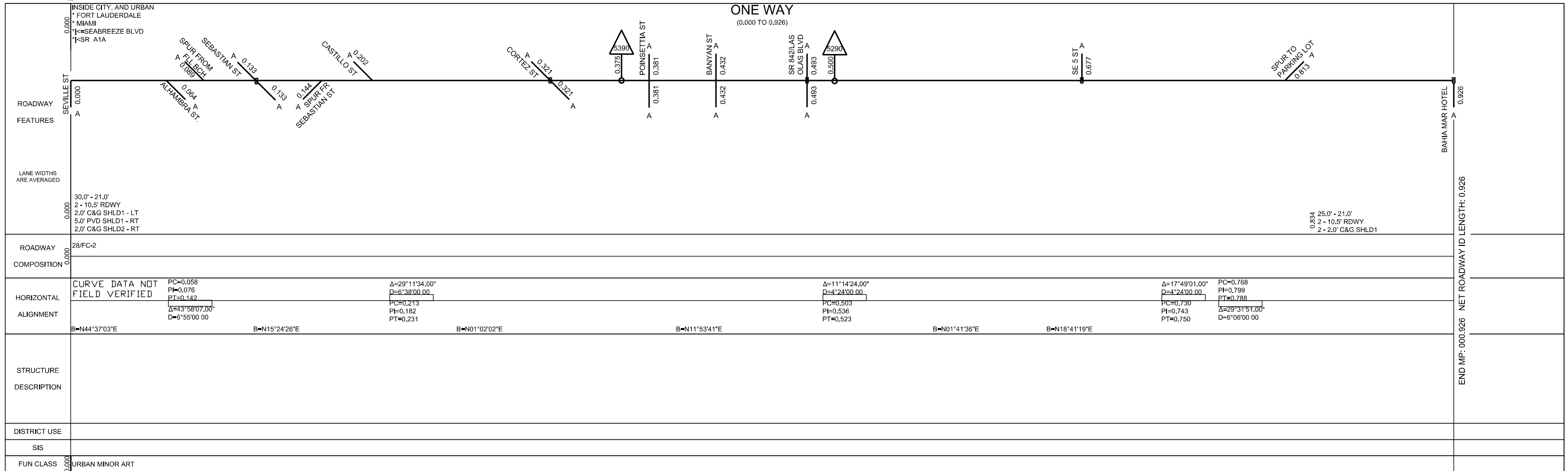

ROADWAY FEATURES	INSIDE CITY, AND URBAN * FORT LAUDERDALE * MIAMI 1<=SEABREEZE BLVD 1<=SR A1A											
LANE WIDTHS ARE AVERAGED	30.0' - 21.0' 2 - 10.5' RDWY 2.0' C&G SHLD1 - LT 5.0' PVD SHLD1 - RT 2.0' C&G SHLD2 - RT											
ROADWAY COMPOSITION	28/FC-2											
HORIZONTAL ALIGNMENT	<table border="0"> <tr> <td>PC=0.058 PI=0.076 PT=0.142 Δ=43°58'07.00" D=6°55'00.00"</td> <td>Δ=29°11'34.00" D=6°38'00.00" PC=0.213 PI=0.182 PT=0.231</td> <td>Δ=11°14'24.00" D=4°24'00.00" PC=0.503 PI=0.536 PT=0.523</td> <td>Δ=17°49'01.00" D=4°24'00.00" PC=0.730 PI=0.743 PT=0.750</td> <td>PC=0.768 PI=0.799 PT=0.788 Δ=29°31'51.00" D=6°06'00.00"</td> </tr> <tr> <td>B=N44°37'03"E</td> <td>B=N15°24'26"E</td> <td>B=N01°02'02"E</td> <td>B=N11°53'41"E</td> <td>B=N01°41'36"E B=N18°41'19"E</td> </tr> </table>		PC=0.058 PI=0.076 PT=0.142 Δ=43°58'07.00" D=6°55'00.00"	Δ=29°11'34.00" D=6°38'00.00" PC=0.213 PI=0.182 PT=0.231	Δ=11°14'24.00" D=4°24'00.00" PC=0.503 PI=0.536 PT=0.523	Δ=17°49'01.00" D=4°24'00.00" PC=0.730 PI=0.743 PT=0.750	PC=0.768 PI=0.799 PT=0.788 Δ=29°31'51.00" D=6°06'00.00"	B=N44°37'03"E	B=N15°24'26"E	B=N01°02'02"E	B=N11°53'41"E	B=N01°41'36"E B=N18°41'19"E
PC=0.058 PI=0.076 PT=0.142 Δ=43°58'07.00" D=6°55'00.00"	Δ=29°11'34.00" D=6°38'00.00" PC=0.213 PI=0.182 PT=0.231	Δ=11°14'24.00" D=4°24'00.00" PC=0.503 PI=0.536 PT=0.523	Δ=17°49'01.00" D=4°24'00.00" PC=0.730 PI=0.743 PT=0.750	PC=0.768 PI=0.799 PT=0.788 Δ=29°31'51.00" D=6°06'00.00"								
B=N44°37'03"E	B=N15°24'26"E	B=N01°02'02"E	B=N11°53'41"E	B=N01°41'36"E B=N18°41'19"E								
STRUCTURE DESCRIPTION												
DISTRICT USE												
SIS												
FUN CLASS	URBAN MINOR ART											

END MP: 0.000.926 NET ROADWAY ID LENGTH: 0.926