

5 YR INV	SLD REV	BMP	EMP	INV	SLD REV
DATE 04/19/2016	04/20/2016	16.550	16.658	11/30/2016 METRIC	12/05/2016 METRIC
BY Metric Engineering, Inc.	Metric Engineering, Inc.	0.000	17.994	10/11/2016 METRIC	10/14/2016 METRIC

FLORIDA DEPARTMENT OF TRANSPORTATION
STRAIGHT LINE DIAGRAM OF ROAD INVENTORY

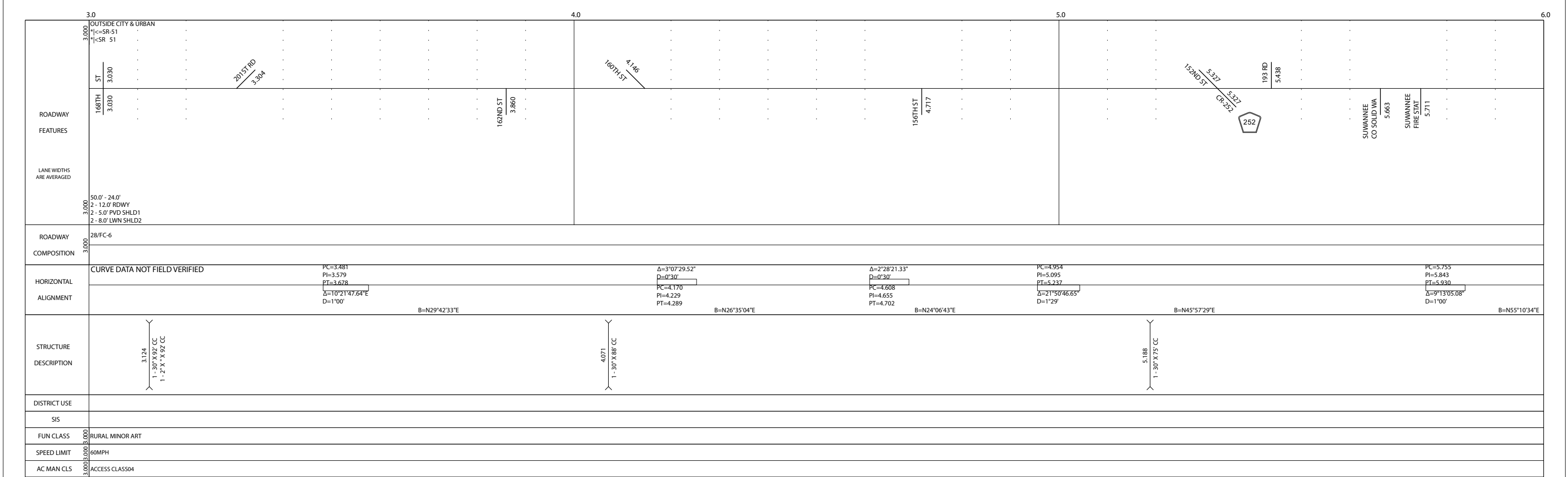

SECTION STATUS	INT. or US ROUTE NO.	STATE ROAD NO.	COUNTY	DISTRICT	ROADWAY ID	SHEET NO.
02		SR 51	SUWANNEE	02	37060000	1 OF 3

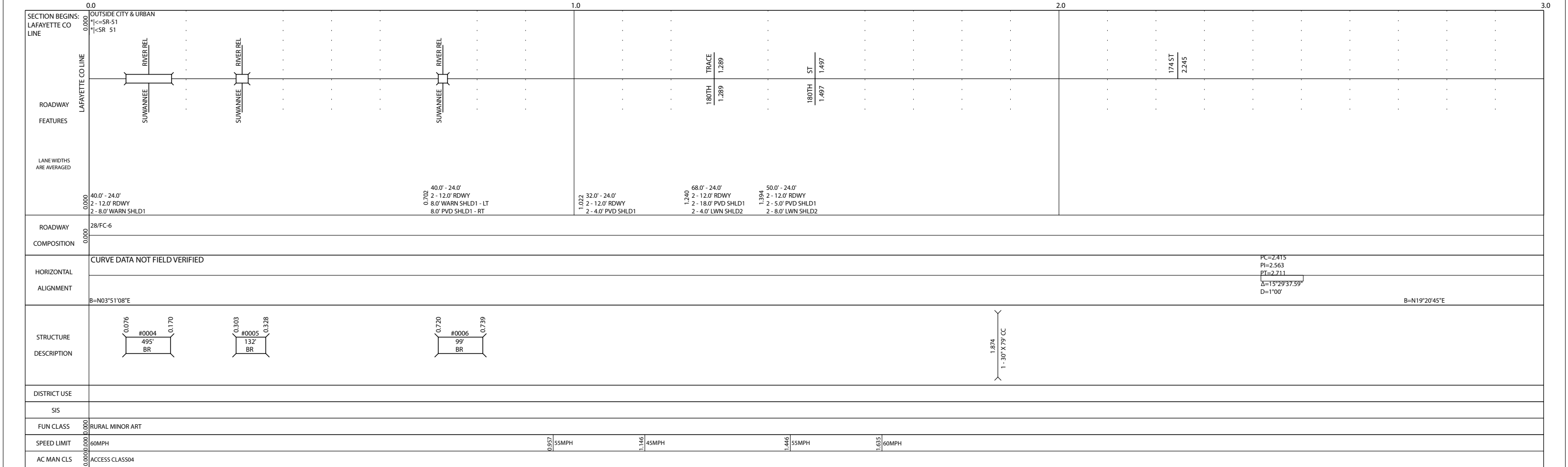

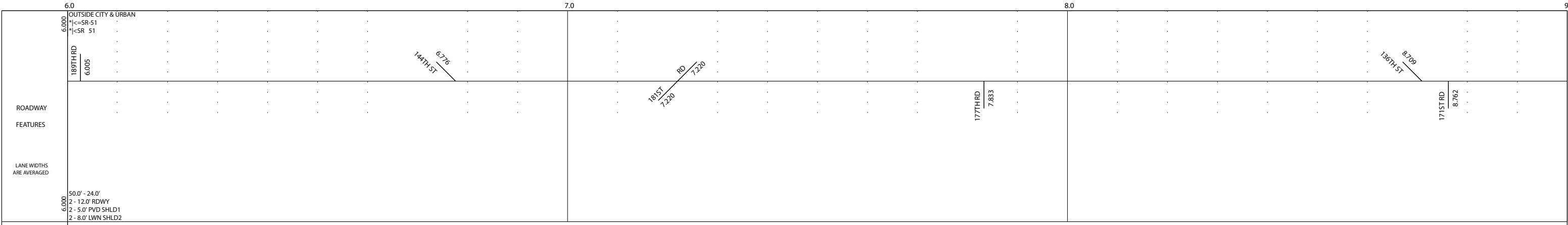

ROADWAY COMPOSITION	28/FC-6												
---------------------	---------	--	--	--	--	--	--	--	--	--	--	--	--

HORIZONTAL ALIGNMENT	CURVE DATA NOT FIELD VERIFIED												
	$\Delta=0^{\circ}49'04.97''$ $D=0^{\circ}10'$ $PC=6.351$ $PI=6.397$ $PT=6.444$ $B=N54^{\circ}21'29''E$								$\Delta=1^{\circ}39'52.64''$ $D=0^{\circ}10'$ $PC=7.459$ $PI=7.553$ $PT=7.648$ $B=N52^{\circ}41'37''E$				$PC=8.942$ $PI=9.046$ $PT=9.151$ $\Delta=1^{\circ}50'28.30''$ $D=10^{\circ}00'$



DISTRICT USE													
SIS													
FUN CLASS	RURAL MINOR ART												
SPEED LIMIT	60MPH												
AC MAN CLS	ACCESS CLASS04												

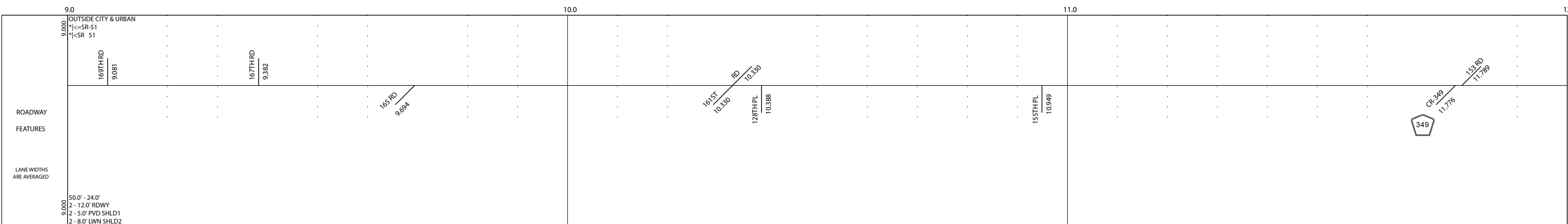

ROADWAY COMPOSITION	28/FC-6												
---------------------	---------	--	--	--	--	--	--	--	--	--	--	--	--

HORIZONTAL ALIGNMENT	CURVE DATA NOT FIELD VERIFIED												
	$\Delta=11^{\circ}02'33.03''$ $D=1^{\circ}00'$ $PC=9.966$ $PI=10.071$ $PT=10.176$ $B=N54^{\circ}32'06''E$				$\Delta=11^{\circ}02'33.03''$ $D=1^{\circ}00'$ $PC=9.966$ $PI=10.071$ $PT=10.176$ $B=N43^{\circ}29'33''E$				$\Delta=3^{\circ}48'50.07''$ $D=0^{\circ}20'$ $PC=11.527$ $PI=11.635$ $PT=11.744$ $B=N39^{\circ}40'43''E$				$PC=11.805$ $PI=11.892$ $PT=11.980$ $\Delta=6^{\circ}54'39.22''$ $D=0^{\circ}45'$ $B=N46^{\circ}35'21''E$



DISTRICT USE													
SIS													
FUN CLASS	RURAL MINOR ART												
SPEED LIMIT	60MPH												
AC MAN CLS	ACCESS CLASS04												

